

Specifiche: WV-ASC970

Supported Equipment	Supported Cameras	Panasonic Analog cameras, Panasonic i-Pro series Network cameras except WV-NM100, WV-NP472, WV-NS320 series, WV-NW470S series
	Supported Recorders	WJ-ND400 series, WJ-ND300 series, WJ-ND200 series, WJ-HD316 series, WJ-RT416 series, WJ-HD600 series
	Supported Switchers	WJ-SX850, WJ-SX650EX
	Supported Encoders	WJ-NT304, WJ-NT314, WJ-GXE900 (MPEG-2 Encoder) ¹
	Supported Decoders	WJ-GXD400, WJ-GXD900 (MPEG-2 Decoder) ¹
	Supported Controller	WV-CU950, WV-ASM970 ²
	Max. Recorder Registrations	64
	Max. Monitor Registrations	512
	Max. Camera Registrations	2,048 (In case with encoder), Analog and/or IP camera ³
	Supported System Type	Multicast/Unicast system
Function	Camera Control (depends on the camera)	Pan/Tilt, Zoom, Focus, Brightness, Preset position call and program (up to 256), Auto mode (SEQ, SORT, AUTO PAN, PATROL), AUX 1 ~ 2
	Recorder Control (depends on the recorder)	REC (only Digital Disk Recorder), Playback
	Sequence Control	Tour Sequence: 128 programs, 64 steps Group Preset: 128 programs, 64 views Group Sequence: 128 programs, 64 steps
	Camera Title Display	On the WJ-GXD400 and Analog Monitor
	Alarm Source	Panasonic alarm protocol by Recorder, Camera, Encoder, RS-232C I/O
	Alarm Control	Reset, Auto reset, Arm, Disarm, Ack, Auto ack, All reset
	Alarm Display Mode	Sequence, Hold
	Alarm Action	Camera spot, Tour sequence, Group sequence
	Max. Number of Alarm	1,024
	System Log	Operation, Alarm, Switching, Video loss
	User Management	Registration: Up to 512 users, ID: 5 digit, PW: 5 digit, User level: customize
	Simultaneous Login Users	Up to 64 (depends on network conditions)
	Partitioning	Operator - Controller, Controller - Monitor, Controller - Camera, Camera - Monitor
	Security Method	User authentication, Controller authentication (MAC address)
	Time Synchronization	NTP (Server/Client)
GUI (Admin) Language	English	
Server Requirement	Supported OS	Red Hat Enterprise Linux 5.3 server (x86)(English)
	Required PC	CPU: Intel® Xeon® Processor 5140 (2.33 GHz) or faster, RAM: 2 GB or more, Network: 2x 100/Gigabit or more, HDD: 80 GB or more free drive space, CD-ROM, Port: 1x RS-232C
Admin Console PC Requirement	Supported OS	Microsoft® Windows® XP Professional SP3 (English and Chinese Version) Microsoft® Windows Vista® Business 32-bit SP2 (English and Chinese Version) Microsoft® Windows® 7 Professional 32-bit (English and Chinese Version)
	Required PC	CPU: Intel® Pentium® 4 processor 3.0 GHz or faster RAM: 512 MB or more Network: 10/100 Mbps HDD: 200 MB or more free drive space Monitor: 32-bit colors, 1,024 x 720 resolution
Network	Protocol	HTTP (IP address and port No.), FTP

*1 NTSC only *2 WV-ASM970 will be supported from Mar/2010. *3 Depends on system configuration

Specifiche: WV-ASM970

Supported Equipment	Supported Server	WV-ASC970 ¹	
	Supported System Type	Multicast/Unicast system	
	GUI Function	Camera Control (depends on the camera)	Pan/Tilt, Zoom, Focus, Brightness, Preset position call (up to 256), Auto Pan, AUX1-2
		Recorder Control (depends on the recorder)	REC (only Digital Disk Recorder), Play, Rev Play, Pause, Stop, FF, REW, Prev Image, Next Image, Goto Last, Goto Date
		Wall Monitor Control	Display division pattern switch, Camera select switch, Tour sequence, Group preset, Group sequence, Monitor lock
	Event Search	Target: Recorder (Camera) Search criteria: Time date, Event type	
	Multiscreen Mode	Spot / Quad (A-D) / 7 split / 9 split / 13 split / 16 split	
	Display Performance	30 ips x 16 screens at MPEG-4 2 Mbps 30 ips x 16 screens at H.264 1.5 Mbps with VGA	
	Multi-Monitor	2 Monitors (Operation/Monitor)	
	Number of Maps	Up to 100 maps (JPEG or Bitmap), Link: 64 cameras/map	
Image Download	Recorded images of up to 64 (in case with WJ-ND400) can be downloaded. Manual download only. Viewer software can be extracted from the main software.		
Clock Display	On the GUI. Time: 12H/24H, Date: 5 formats		
Alarm Control	Reset, All reset, Arm, Disarm, Ack, Auto ack		
System Setup	Setup page in English, Chinese		
GUI Language	English, Chinese		
PC Requirement	Supported OS	Microsoft® Windows® 7 Professional (32-bit) (English and Chinese Version) Microsoft® Windows® 7 Professional (64-bit) ² (English and Chinese Version) Microsoft® Windows Vista® Business SP2 (32-bit) (English and Chinese Version) Microsoft® Windows Vista® Business SP2 (64-bit) ² (English and Chinese Version) Microsoft® Windows® XP Professional SP3 (32-bit) (English and Chinese Version)	
	Supported Browser	Microsoft® Internet Explorer® 6.0 Service Pack 3 Microsoft® Internet Explorer® 7.0 Service Pack 1 Microsoft® Internet Explorer® 8.0	
	Required PC	CPU: Intel® Core™ 2 Duo 2.66 GHz or faster / Intel® Core™ 2 Quad Q9650 or faster (When operating H.264 images) / Intel® Core™ i7-920 or faster (When operating H.264 images), Memory: 2 GB or more / 3 GB or more (When operating H.264 images), VRAM: 128 MB or more, compatible with DirectX® 9.0c	
Network	Protocol	HTTP (IP address and port No.), FTP	
Viewer Software	Playback Control	Play, Rev Play, Pause, FF, REW, Prev Record, Next Record, Prev Image, Next Image	
	Additional Functions	Alteration detection, Save as JPEG, Two times zoom, Print	

*1 WV-ASC970 Version 2.0 or later *2 Operation in WOW64 (32-bit mode)

Flessibile gestione degli allarmi

Flexible alarm actions can be assigned for each alarm.
Up to 1,024 alarms can be registered.

Alarm actions include:

- Display alarm information on the designated monitor
- Display alarm images from the camera or start the sequence display on the designated monitor
- Turn on the alarm indicator on all the system controllers and WV-ASM970

* The WV-ASC970 does not support any error notifications (such as "REMOVE") from digital disk recorders or network disk recorders.

Alarm action example

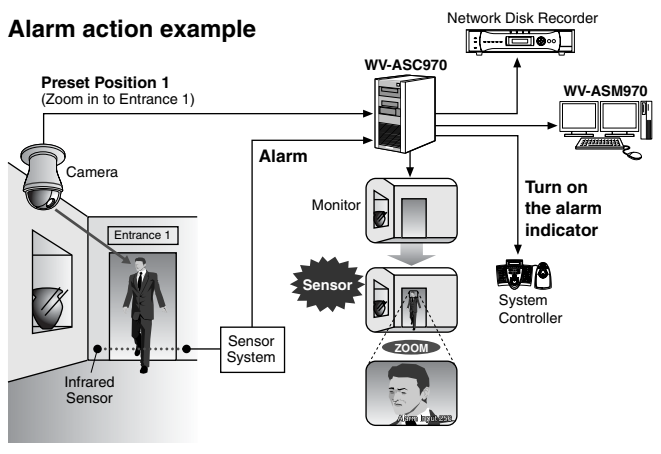

Trademarks and registered trademarks

- "Red Hat" is a trademark of Red Hat in the U.S. and other countries.
- Intel, Xeon and Pentium are registered trademarks of Intel Corporation.
- "Super Dynamic", "SDII", "SDIII" and "i-Pro" logos are trademarks or registered trademarks of Panasonic Corporation.

Important

- Safety Precaution: carefully read the operating instructions and installation manual before using this product.
- Panasonic can not be responsible for network performance and/or other manufacturer products that reside on the network.

- All TV pictures are simulated.
- Weights and dimensions are approximate.
- Specifications are subject to change without notice.
- These products may be subject to export control regulations.
- All product pictures are NTSC models.

DISTRIBUTED BY:

Panasonic®

<http://panasonic.net/security/>

Printed in Japan (2A-052BA)